

direct operated solenoid valves

coil 15 mm

general information	
ambient temperature	- 10°C to + 50°C
response time	3- 5 ms
mounting	in any position
standard seal materials*	NBR
dimensions	see page 2/3
coil data	see page 2/3
connector data	see page 2/3
sub-base	see page 3/3

inlet port for:  
normally open 3  
normally closed 1

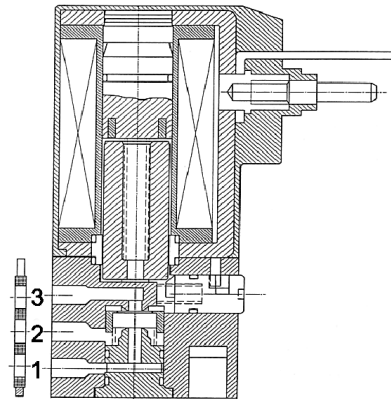

\* other seal materials on request

function	symbol	orifice mm	*Kv	pressure range (bar)			nominal power		TABLE A main code
				min.	max. DC	max. AC	Watt DC	V.A. AC inr. hol.	
<b>2/2 normally closed (NC)</b> 	0.8	0.28	0	-	10	-	3.6	2.5	<b>A2M108</b>
	0.8	0.28	0	10	-	1	-	-	<b>A2M608</b>
	1.2	0.40	0	-	10	-	3.6	2.5	<b>A2M112</b>
	1.2	0.40	0	10	-	1.5	-	-	<b>A2M612</b>
	1.5	0.55	0	-	5	-	3.6	2.5	<b>A2M115</b>
	1.5	0.55	0	5	-	2	-	-	<b>A2M615</b>
<b>2/2 normally open (NO)</b> 	0.8	0.28	0	-	10	-	3.6	2.5	<b>A2M208</b>
	0.8	0.28	0	10	-	1	-	-	<b>A2M708</b>
	1.2	0.40	0	-	10	-	3.6	2.5	<b>A2M212</b>
	1.2	0.40	0	10	-	1.5	-	-	<b>A2M712</b>
	1.5	0.55	0	-	5	-	3.6	2.5	<b>A2M215</b>
	1.5	0.55	0	5	-	2	-	-	<b>A2M715</b>

\*l/min. of water with ΔP of 1 bar

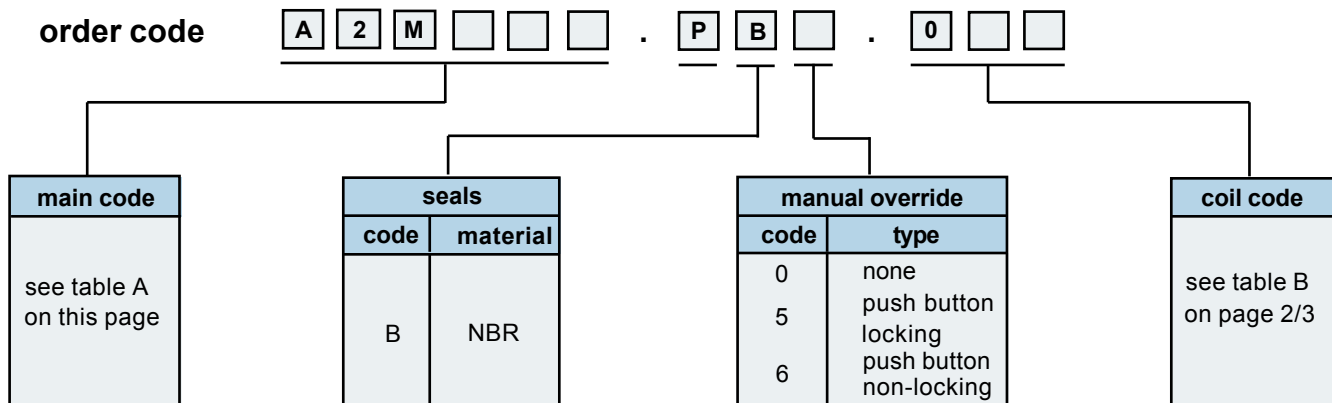

direct operated solenoid valves

coil 15 mm

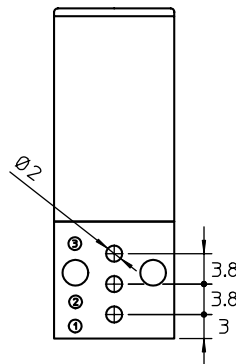
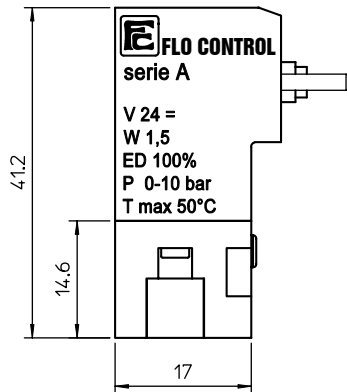
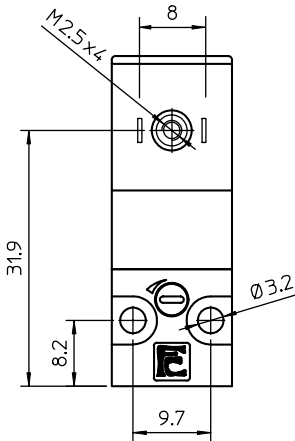
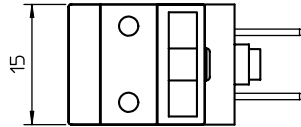
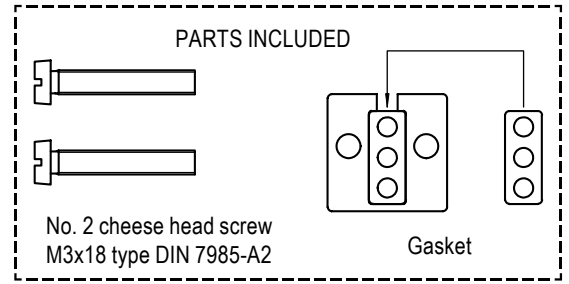

Terminals for connector DIN 43650-C

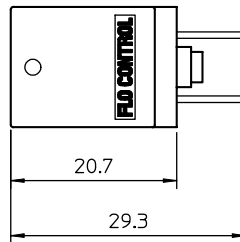
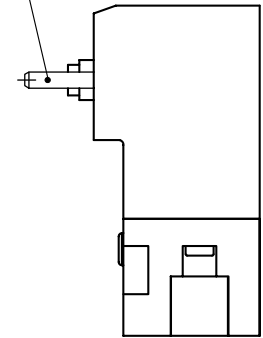

<b>weight</b>	36 g
---------------	------

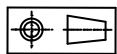

coil code	TABLE B				
	*voltages	code			
		- 50 Hz - 60 Hz	= DC		
		1 W	1.5 W	2 W	
12	-	067	066	068	
	011	070	071	073	
110	021	-	-	-	
230	031	-	-	-	

coil specification	
<b>wire insulation</b>	class H180° C
<b>encapsulation</b>	class F155° C
<b>encapsulation mat.</b>	nylon
<b>energising duration</b>	100% at 20° C ambient
<b>voltage variation</b>	- 10% +15% of nom. volt.
<b>power consumption</b>	AC- 2,5 VA DC- 1 - 1.5 - 2 Watt
<b>electrical connection</b>	AMP 2.8 x 0.5 (2P+ earth)
<b>cable connection</b>	Pg 7 (for cable dia. 4-6mm)
<b>protection class</b>	IP 65 (with connector )

\* other voltages and wattages on request

**connector** (not included, must be ordered separately)

<b>code</b>	Z10029
-------------	--------

**FLO CONTROL**  
Solenoid Valves

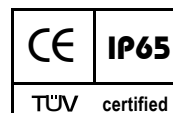



direct operated solenoid valves

coil 15 mm

general information	
ambient temperature	- 10°C to + 50°C
response time	3- 5 ms
mounting	in any position
standard seal materials*	NBR
dimensions	see page 2/3
coil data	see page 2/3
connector data	see page 2/3
sub-base	see page 3/3

inlet port for:  
normally open 3  
normally closed 1

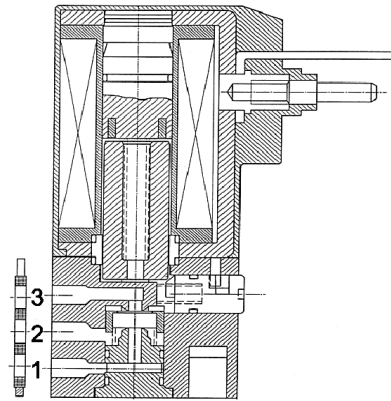

\* other seal materials on request

function	symbol	orifice mm	*Kv	pressure range (bar)			nominal power		TABLE A main code	
				min.	max. DC	max. AC	Watt DC	V.A. AC inr. hol.		
<b>3/2 normally closed (NC)</b> 		0.8	0.28	0	-	10	-	3.6	2.5	<b>A3M108</b>
		0.8	0.28	0	10	-	1	-	-	<b>A3M608</b>
		1.2	0.40	0	-	10	-	3.6	2.5	<b>A3M112</b>
		1.2	0.40	0	10	-	1.5	-	-	<b>A3M612</b>
		1.5	0.55	0	-	5	-	3.6	2.5	<b>A3M115</b>
		1.5	0.55	0	5	-	2	-	-	<b>A3M615</b>
<b>3/2 normally open (NO)</b> 		0.8	0.28	0	-	10	-	3.6	2.5	<b>A3M208</b>
		0.8	0.28	0	10	-	1	-	-	<b>A3M708</b>
		1.2	0.40	0	-	10	-	3.6	2.5	<b>A3M212</b>
		1.2	0.40	0	10	-	1.5	-	-	<b>A3M712</b>
		1.5	0.55	0	-	5	-	3.6	2.5	<b>A3M215</b>
		1.5	0.55	0	5	-	2	-	-	<b>A3M715</b>

\*l/min. of water with ΔP of 1 bar

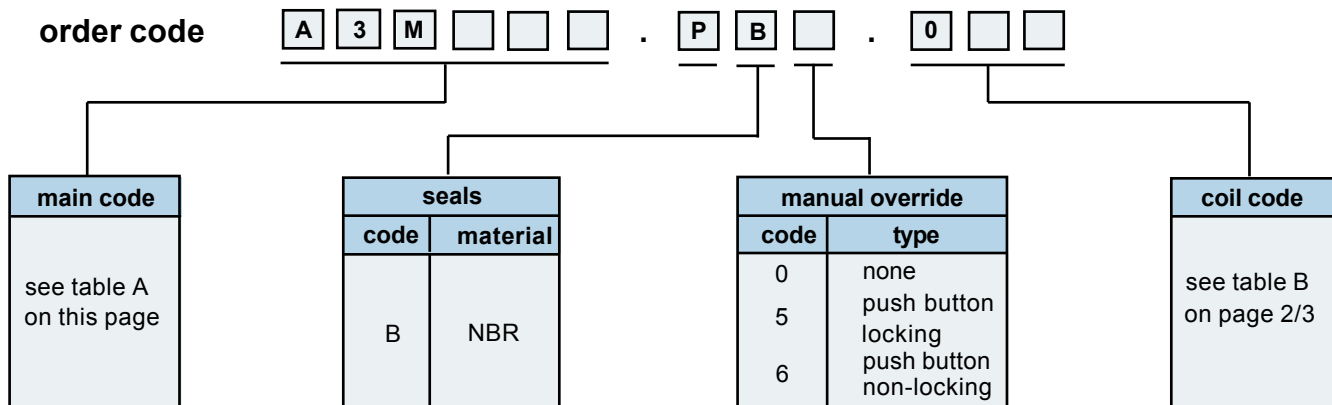

direct operated solenoid valves

coil 15 mm

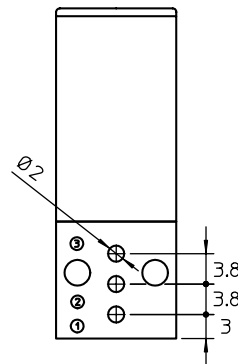
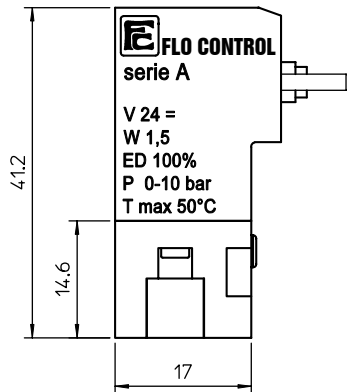
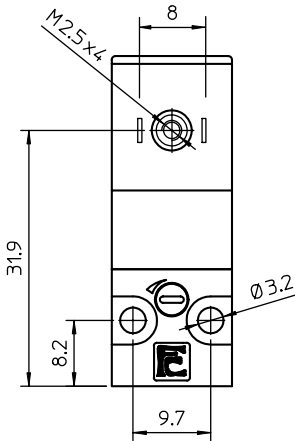
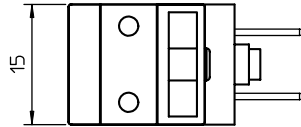
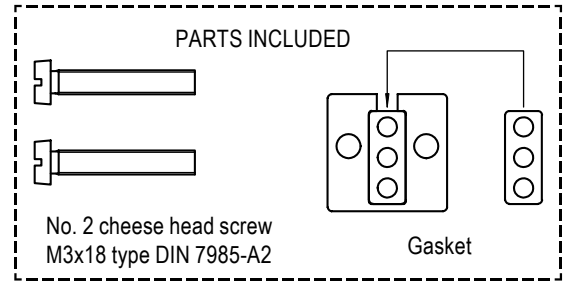

Terminals for connector DIN 43650-C

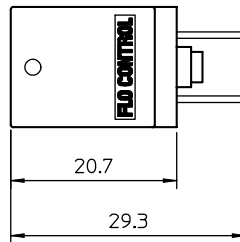
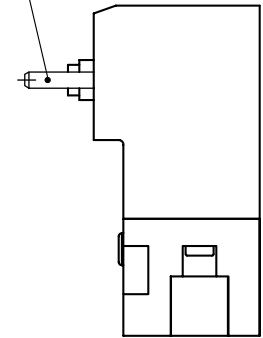

<b>weight</b>	36 g
---------------	------

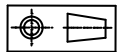

coil code	TABLE B				
	*voltages	code			
		- 50 Hz - 60 Hz	= DC		
		1 W	1.5 W	2 W	
12	-	067	066	068	
	011	070	071	073	
110	021	-	-	-	
230	031	-	-	-	

coil specification	
<b>wire insulation</b>	class H180° C
<b>encapsulation</b>	class F155° C
<b>encapsulation mat.</b>	nylon
<b>energising duration</b>	100% at 20° C ambient
<b>voltage variation</b>	- 10% +15% of nom. volt.
<b>power consumption</b>	AC- 2,5 VA DC- 1 - 1.5 - 2 Watt
<b>electrical connection</b>	AMP 2.8 x 0.5 (2P+ earth)
<b>cable connection</b>	Pg 7 (for cable dia. 4-6mm)
<b>protection class</b>	IP 65 (with connector )

\* other voltages and wattages on request

**connector** (not included, must be ordered separately)

<b>code</b>	Z10029
-------------	--------

**FLO CONTROL**  
Solenoid Valves

